



Chico Unified School District Safety and Security Report

June 2014

Introduction

During the District Wide Facilities Master planning process many comments concerning school safety and security were received by the Chico Unified School District Facilities Department. As part of Phase I – Quick Start projects funds totaling approximately \$3,000,000.00 were set aside for the most critical of concerns. The D.I.R.T. (District's Incident Response Team), whose purpose is to review all concerns of safety and security of students, was invited to participate in determining the needs on each campus. In addition, school site administration reviewed each site in the District for safety and security concerns. The District Office staff reviewed the Administrative Office Campus and the District Corp Yard was reviewed by the District Facilities and others from the site. An internet survey was prepared and all sites were asked to participate. Over 290 responses were received from the survey. The survey contained these questions:

- At what school do you work?
- How do you get to work?
- Do you have safety concerns when entering or leaving a school campus?
- How often are you on campus on non-school hours?
- Do you feel comfortable on campus during non-school hours?
- Do you believe that your school is safe and secure during school?
- What is your biggest safety and security concern during the school day?
- What do you feel would be the best addition to the school that would improve safety and security?

Overall the top concerns voiced in the survey were:

- Homeless and other unauthorized use of school grounds before and after school and on weekends including road access
- Traffic problems especially at pick-up and drop-off times
- Poor exterior lighting
- The large number of entrances to the school campuses

The survey results are contained in the body of this report in both written and graphical format.

Individual School Site Council's reviewed each site. The meeting attendance varied, but generally the Principal of the school, custodial staff, the District facilities department, and community members listened to the purpose of the meeting, gave input and participated in the discussion. These discussions lead to the creation of a general plan for each site indicating potential projects to improve school safety and security. Each school site council was also asked to prioritize the various projects.

The school site general safety and security plans are contained in the body of this report.

The school sites generated a number of good results, far exceeding the budgetary limits set by the facilities master plan. A meeting was held with D.I.R.T. to review and set overall District priorities. D.I.R.T. asked for additional information on the cost and priority of each project. The committee also agreed that schools with improvement projects in the 2nd and 3rd phase should be excluded because the safety concerns could be addressed as part of the bigger improvement projects

A rough order of magnitude cost estimate for each site in phase 4 and above in the master plan was prepared and presented at the next D.I.R.T. meeting.

D.I.R.T. reviewed the documentation and created a list of the top 6 priorities.

1. Purchase and install Door Lock Blocks for all exterior doors to classrooms in every school facility on every campus
2. Purchase and install Window Coverings for all windows of classrooms in every school facility on campuses that do not currently have window coverings
3. Design, purchase and install clear school identification and directional signage to school administration on those campuses without such signage
4. Design, purchase and install gates and fences (maximum height 6 feet) at campuses where indicated on school site priority maps, to improve a single point of entry to a campus "during school hours" concept. The single point of entry should be located at the administration building.
5. Purchase and install surveillance cameras and security lighting where indicated on school site priority maps
6. Design and install speed bumps, cross walks and other stripping as indicated on the school site priority maps. Where possible, work with the City of Chico to coordinate design and installation expenses

The District Facilities Department will move forward with implementing the priorities. The D.I.R.T. also requested the Facilities Department to evaluate some of the school map's project scope before implementation, which were disproportionate in scale to the others schools, to insure equity across the District.

Project Summary

The school site meetings prioritized the various projects on each site with the initial site prioritization shown in the color coding. A “rough order of magnitude” cost was estimated for each project on each site.

School	MP Phase for Mod.	Fencing	Gates	Lighting	Camera	Cross Walk	Speed Bumps	Striping	Window Coverings	Parking or Traffic Revisions	Improve Grounds	Door Locks	Signage	Access	Other	Total
Chapman	5	\$31,533	\$2,007	\$7,106			\$3,213					\$10,863			\$75,000	\$54,723
Citrus	5	\$76,205	\$6,021	\$10,676	\$12,349			\$1,847				\$63,370				\$170,469
Emma Wilson	4	\$35,475	\$10,036	\$25,309	\$15,437	\$369										\$86,626
Hooker Oak	4		\$4,014	\$12,436		\$369	\$1,285	\$1,231							\$5,000	\$24,336
Little Chico Creek	Future	\$15,767	\$20,071					\$739	\$116,681							\$153,257
McManus	5		\$6,021			\$369		\$3,078							\$842,112	\$851,581
Neal Dow	3		\$4,014	\$5,330												\$9,344
Parkview	5	\$3,942	\$4,014	\$5,330	\$9,262			\$616	\$35,000			\$5,000				\$63,163
Rosedale	4	\$5,256	\$4,014	\$8,017				\$923				\$1,811				\$20,021
Shasta	Future	\$26,278	\$6,021			\$1,285	\$616								\$15,000	\$49,200
Sierra View	4	\$5,256	\$4,014							\$107,072						\$116,342
Chico Sr High	6		\$6,021	\$19,796	\$24,699			\$19,447								\$69,963
Inspire	6	\$2,628	\$2,007	\$19,815	\$21,611											\$46,061
Pleasant Valley High	4&6	\$5,256	\$8,029		\$37,048				\$30,780							\$81,112
Fairview High	5			\$162,622				\$68,064				\$2,716	\$5,000		\$15,000	\$253,402
District Admin	7			\$3,553										\$7,500		\$11,053
Sub Total		\$207,594	\$86,306	\$279,988	\$120,407	\$1,108	\$5,783	\$9,049	\$204,191	\$65,780	\$107,072	\$78,760	\$10,000	\$7,500	\$952,112	\$2,060,651

Other Projects

Chapman	Replace/Repair rotting overhangs
Hooker Oak	ADA Improvements
McManus	Kindergarten and Front Parking Lot
Shasta	Connecting two buildings
Fair View	Cover on gas valve

Notes

Inspire	Lighting and Cameras are on several priorities
	Cost are for planning purposes only

Priority Key

	1st
	2nd
	3rd
	4th
	5th
	6th

This chart was used during the last meeting of D.I.R.T. to identify an overall direction and priority for the District. D.I.R.T. prioritized the various projects into a top six priorities which will be implemented District-wide for priority 1 and 2. Priority 3-6 will be completed on the schools listed in the chart above. These priorities were set based on the understanding of having the best impact to improve overall safety of the District.

Staff Survey

With over 290 responses, the staff survey gave a great snap shot of safety and security perception throughout the District. Although some of the questions were short answer and would be too lengthy to list, summaries and charts are shown below.

The survey was used as a starting place at each campus meeting to simulate conversation and brainstorming solutions.

At what school do you work?

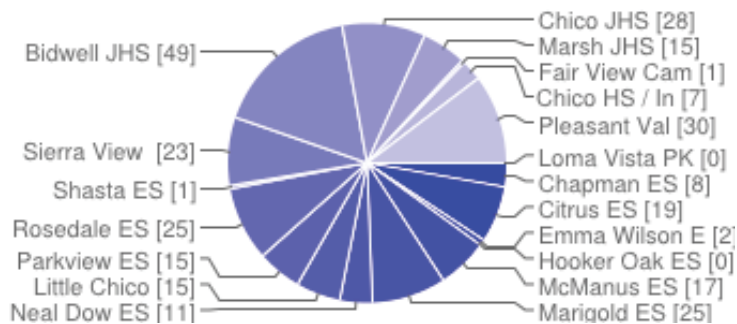

Overall the top concerns voiced in the survey were:

- Homeless and other unauthorized use of school grounds before and after school and on weekends including road access
- Traffic problems especially at pick-up and drop-off times
- Poor exterior lighting
- The large number of entrances to the school campuses

Survey results on coming and going from campus included the following charts. Short answer questions resulted in many comments on parents and students not obeying traffic, parking and crosswalk rules. Suggested improvements included additional information, law enforcement, speed bumps, expansion of lots and drop-off areas and new crosswalks.

How do you get to work?



Do you have safety concerns when entering or leaving the school campus?

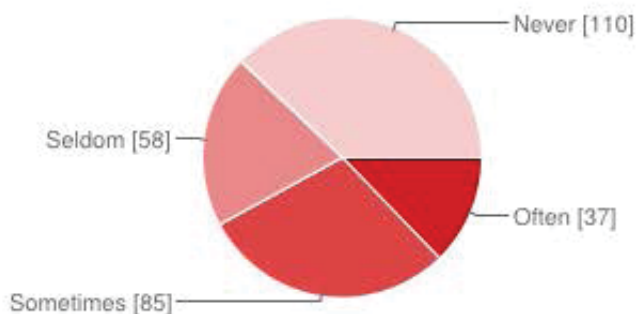

How often are you on campus during non-school hours?

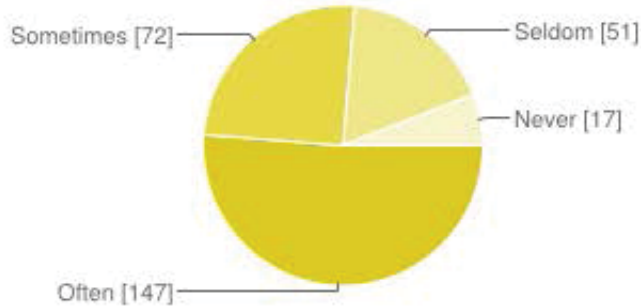

Many staff report coming early and leaving late from campus. To increase safety during these off hours, staff suggested increased exterior lighting, video surveillance, increased fencing or adding gates and providing window coverings so people are not able to see who is within an occupied classroom.

Do you feel uncomfortable on campus during non-school hours?

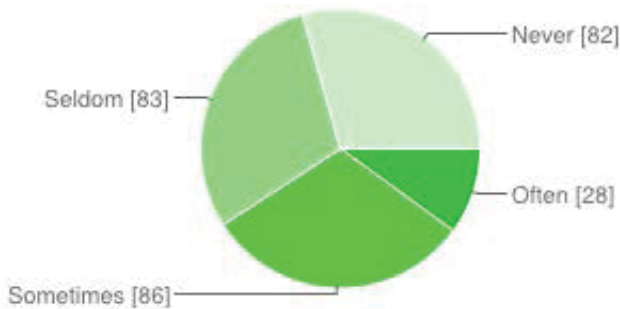

Often	28	10%
Sometimes	86	31%
Seldom	83	30%
Never	82	29%

During the school day, many of the suggest improvements were focused on a controlling entrances, enforcing the use and distribution of visitor badges, providing safe exiting, and being able to close and lock doors and window coverings. Some school sites also commented on the unevenness of the fields, rotting wood and concern over the appearance and functionality of safety solutions.

Do you believe your school is safe and secure during the school

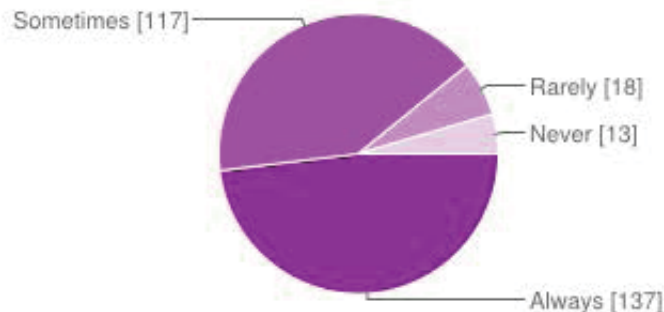

What is your biggest safety and security concern during the school day?

The perimeter around campus is not secure	152	36%
Hidden spaces on the campus	58	14%
Non-human intrusion on campus (e.i. dogs)	31	7%
Field areas / playgrounds	67	16%
None	59	14%
Other	54	13%

What do you feel would be the best addition to the school that would improve safety and security?

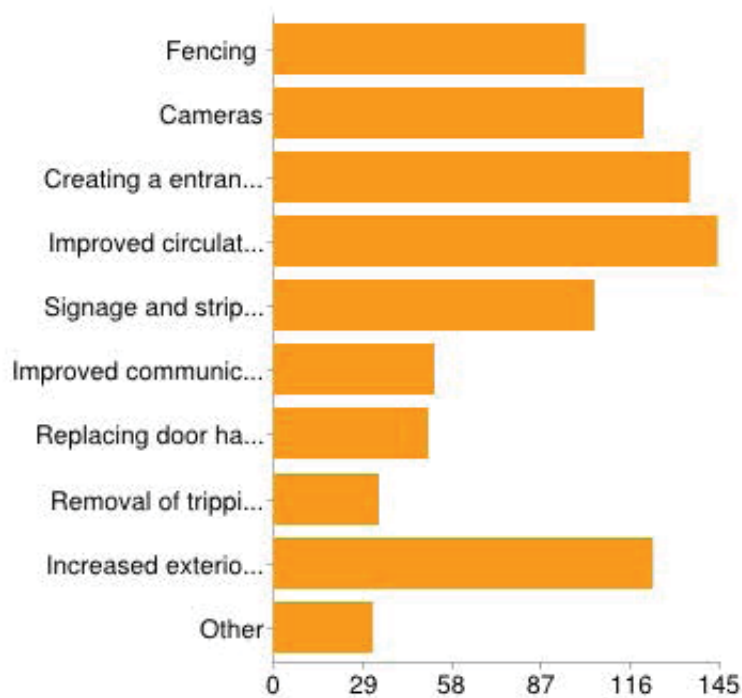

Fencing	101	11%
Cameras	120	13%
Creating a entrance that requires visitors to come through the office	135	15%
Improved circulation in the parking lots	144	16%
Signage and striping in drop-off areas	104	12%
Improved communication tools from the classrooms to the office	52	6%
Replacing door hardware/locks	50	6%
Removal of tripping hazards	34	4%
Increased exterior lighting	123	14%
Other	32	4%

School Site Results

The school site meetings were typically attended by the school site principal, senior custodian and a facilities department staff. Assistant principals, teacher in charge and other school staff occasionally joined the meeting as well.

Each meeting began, after an introduction, with a summary of the survey and how the specific school site staff responded. These responses and the personal experience of the attendees lead to a complete listing of projects that may fit within the scope of the Phase One Safety and Security Projects. After listing the possible projects the site staff was asked to prioritize the various improvements. These were recorded on cards and site plans.

After the creation of the preliminary site plans, a meeting was conducted with the City of Chico and Bike Chico to further explore community initiatives that may effect the transportation around school sites and additional work that can be done to improve safety of all forms of transportation to and from school sites.

The following pages include the results of all the school site meetings and meeting with the City of Chico.

Chapman Elementary School

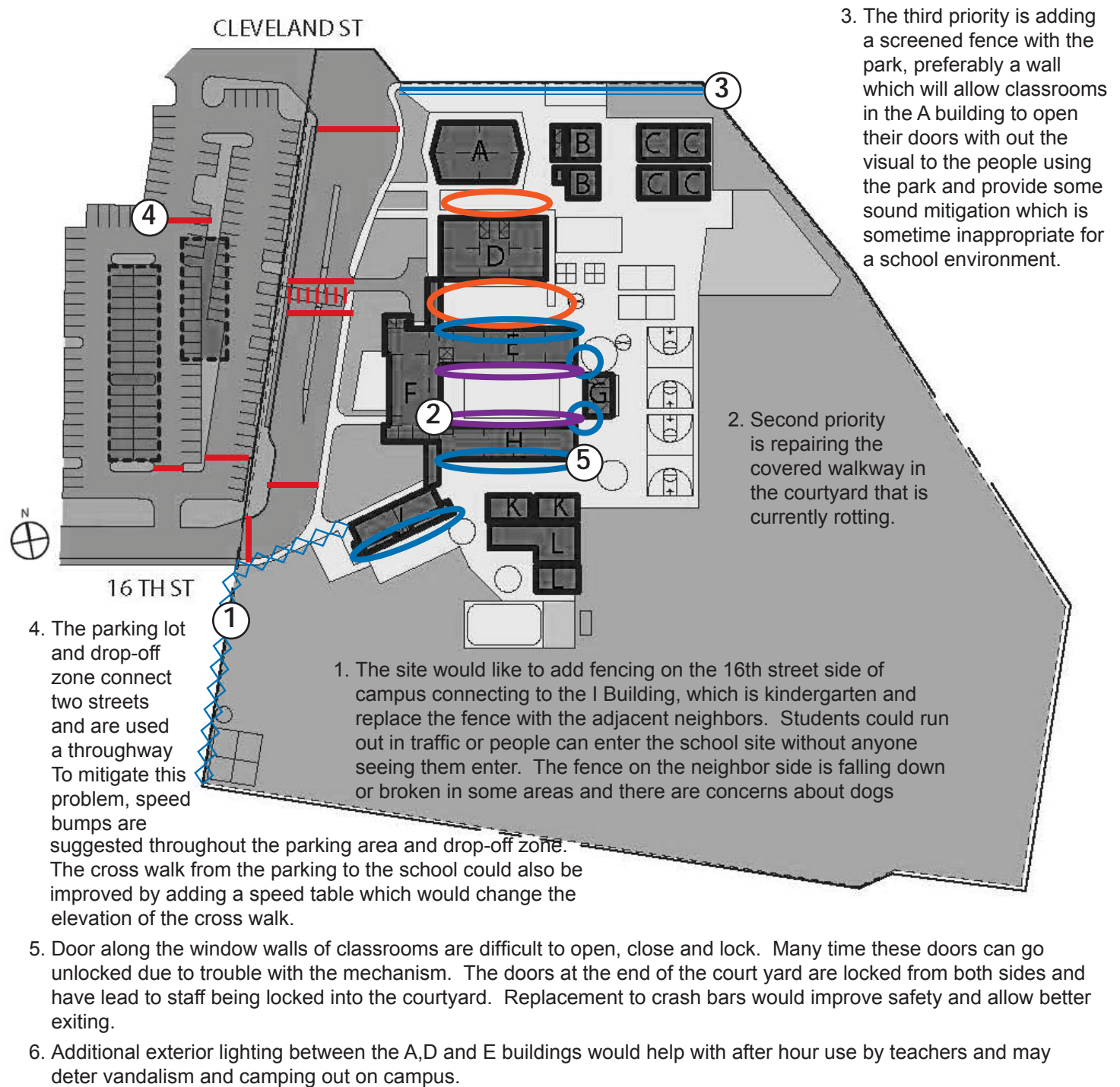

Legend

#	Priority Number	◇◇◇◇	New Fence / Gates	■	Additional Striping
○	Additional Lighting	—	New Wall		New Cross Walk
○	Camera Coverage	○	Replace Door Locks/Doors	—	Speed Bumps
○	Other	////	Wood Replacement	⊗	New Sign

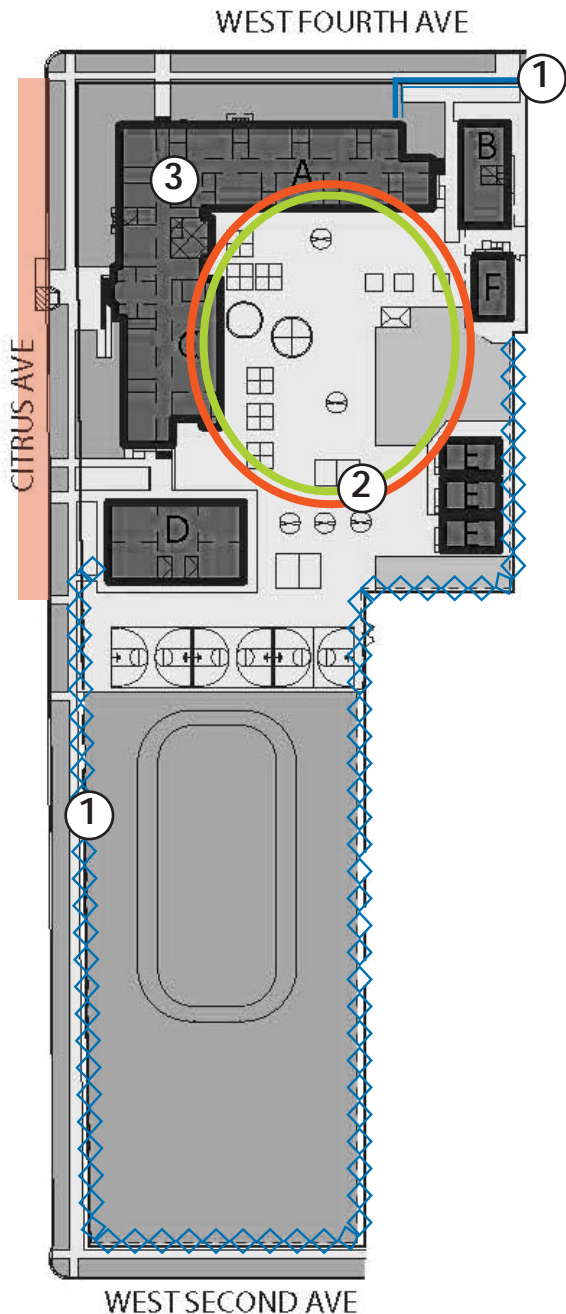

1. First priority is to replace the fence around the playground which is broken or falling down in some areas with an 8 foot fence which is harder to climb. Also replace the fence near the B Building, which houses kindergarten with a fence that blocks visibility to that area because students use the area as an outdoor learning area and the school site has had problems in the past with unwanted observers. When replacing the fence a better fence with hardware that is sturdy and locks is important for keeping a perimeter around the campus. The vehicle size gate is also a problem for locking and the school site would like to see it removed.
2. The courtyard of this school is secluded and during nights and weekends been used for illegal behavior leading to fires and debris that need to be cleaned up after. Increased lighting and video surveillance along with the more secure fence line may help deter this behavior.
3. The third priority is replacing the locks throughout the school. The school has several different masters which make lock downs difficult and there are concerns about the keys being distributed.

In addition to the prioritized concerns, the drop-off areas on Citrus are separated by one small section of parking which does not seem to make much sense and adds to the overall confusion on drop-off and pick-up verses parking areas. Consideration of curb striping and consolidating drop-off verses parking areas may improve these activities.

Legend

#	Priority Number	◇◇◇◇	New Fence / Gates	■	Additional Striping
○	Additional Lighting	—	New Wall		New Cross Walk
○	Camera Coverage	○	Replace Door Locks/Doors	■	Speed Bumps
○	Other	////	Wood Replacement	⊗	New Sign



1. First priority is to add a cross walk that would allow student to walk safely across West 8th Avenue without having to go all the way to Nord Avenue, which they do not do. To increase safety at this crossing, the sidewalk may need to be extended out to the outside of the street parking, so pedestrians can be viewed by oncoming cars.

In addition to the first prioritized need, three other needs were identified.

Fencing along the front walk way on the side that faces the street would direct visitors to the front office. In front of the H Building, which is Kindergarten, the doors lead directly out into the parking/drop-off area and a fence with one gate would help ensure young students do not run into traffic. A fence and gate next to the cafeteria, C Building, and the outdoor lunch area would stop visitors from cutting through campus during the school day.

Video surveillance is being requested to increase with replacement of three existing cameras which are older and new camera coverage, shown in green, to cover the entrances and outdoor hallways.

Additional lighting in the back of the school that is controllable by the school site would improve safety with evening activities are occurring on the school campus.

Legend

#	Priority Number	◇◇	New Fence / Gates	■	Additional Striping
○	Additional Lighting	—	New Wall		New Cross Walk
○	Camera Coverage	○	Replace Door Locks/Doors	—	Speed Bumps
○	Other	////	Wood Replacement	⊗	New Sign

Hooker Oak Elementary School

1. First priority is to additional striping to the two drop-off areas. The drop-off on Arbutus Avenue is for busses only and should be labeled as a bus zone with diagonal striping and red curb. The drop-off on 3rd Avenue is for parents and needs new curb paint and no parking on the drive way. The existing speed bump also does not go all the way across causing cars to swerve to avoid it. The site staff would like to see it extended.

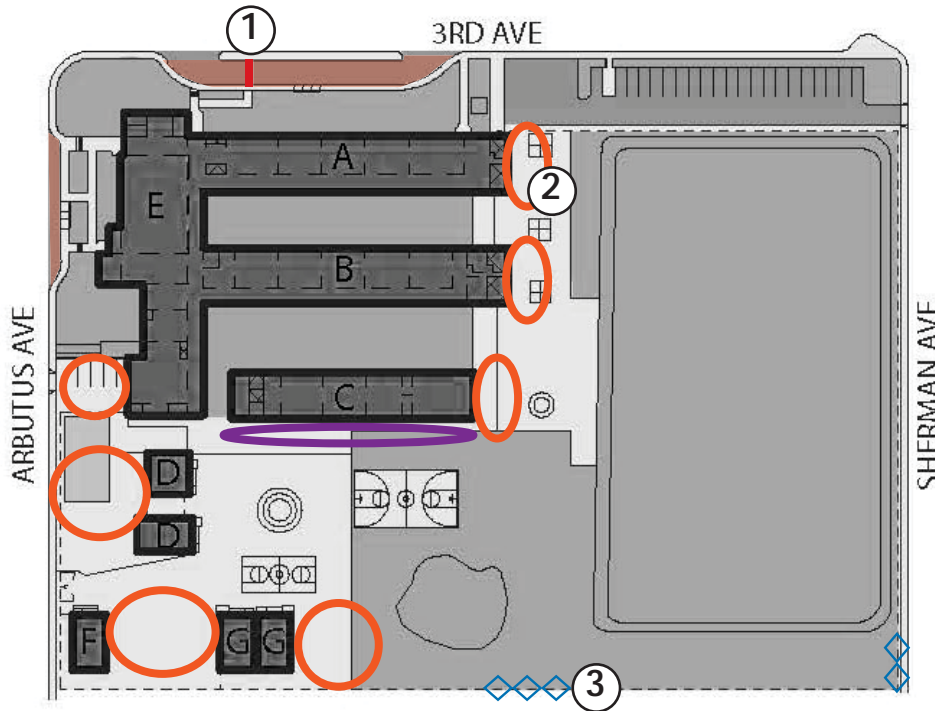

2. Additional lighting is being requested at the ends of the A, B and C wings as well as around the portables. These areas are dark when teachers are entering or exiting campus and additional lighting might deter inappropriate behavior that occurs on the school site on weekends
3. Site staff would like the gate by the play structure to be removed and replaced with only fence. A new gate is also requested for the back corner of the site on Sherman Avenue. These changes would increase security of the perimeter of the campus.

Legend

#	Priority Number	◇◇	New Fence / Gates	■	Additional Striping
○	Additional Lighting	—	New Wall		New Cross Walk
○	Camera Coverage	○	Replace Door Locks/Doors	—	Speed Bumps
○	Other	///	Wood Replacement	⊗	New Sign

1. First priority is to eliminate the gap on the handle side of the exterior gates that connect the buildings. It is very easy for anyone to go through the gates by slipping their hand through the side and using the inside handle to open the gate. This raises many concerns for site staff both during and after school.
2. Second priority is to add window coverings to all classrooms. The only classroom that currently have window coverings are the special education rooms. The lack of window coverings does not allow to visually obstruct the windows in a code red or at night when a teacher is working late.
3. The final priority is to add additional striping to the area used by parents to drop-off students and possibly add a fence to discourage students from walking across the bus lane at other locations than the cross walk

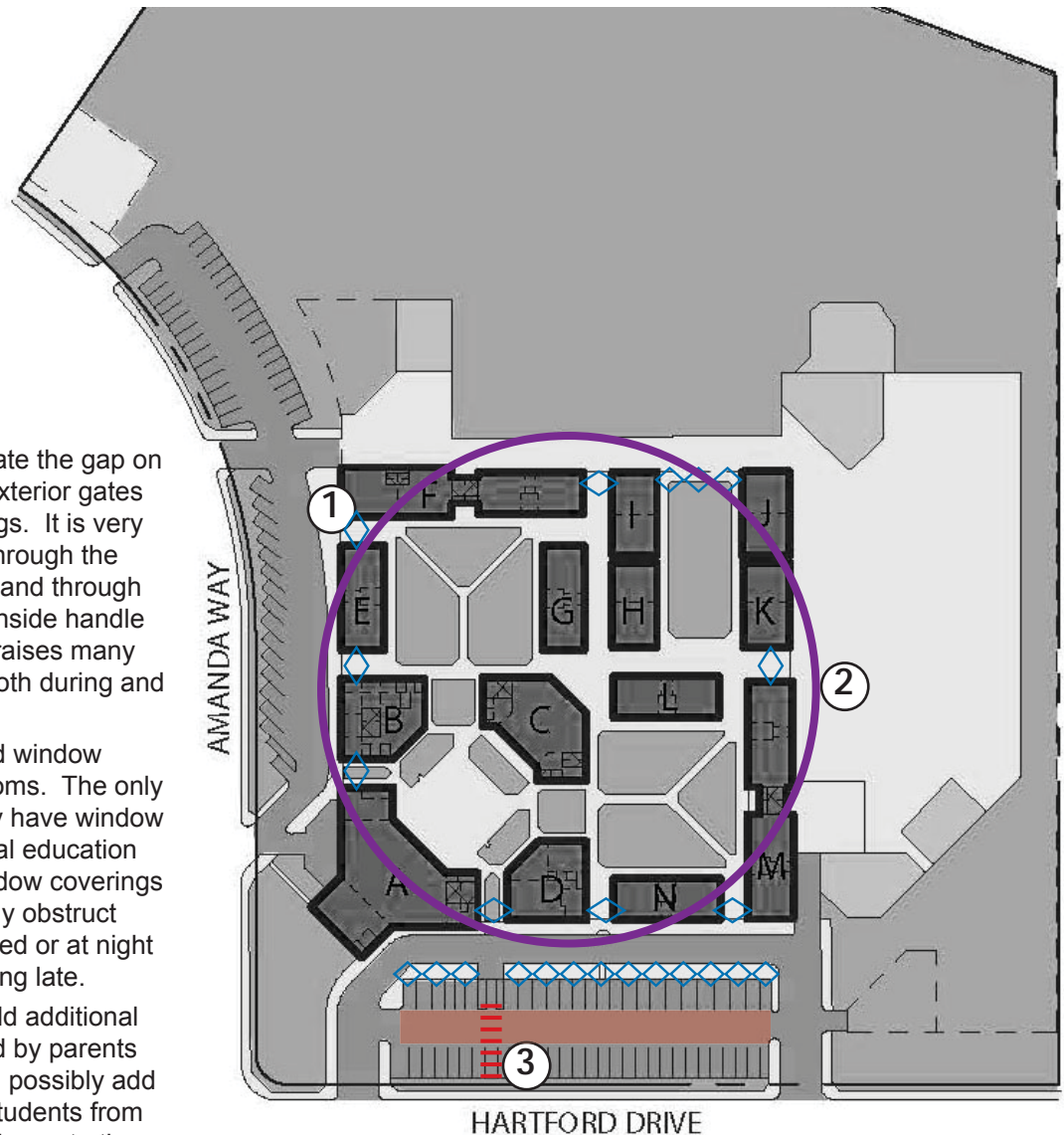

In addition to the prioritized concerns, the current video system is in a back room which makes monitoring the video feed difficult. Moving that into the office would make the video system more useful.

Legend

#	Priority Number	◇◇	New Fence / Gates	■	Additional Striping
○	Additional Lighting	—	New Wall		New Cross Walk
○	Camera Coverage	○	Replace Door Locks/Doors	—	Speed Bumps
○	Other	////	Wood Replacement	⊗	New Sign

Marigold and Loma Vista Elementary School

Traffic is a huge concern on the Marigold campus. Expanding the front parking lot would allow the parking to be consolidated on one side and leave the other side open for drop-off. Another difficulty with the Marigold Avenue parking lot is the bus drops students off on the curb without a good way to get across the parking lot. It was suggested to add a cross walk in the parking lot to provide a path for the students. On East Avenue drop-off, the existing gate is near where cars enter the driveway, which causes parents to stop at the beginning instead of the end of the drop-off area. Moving the gate further down the fence may help encourage parents to go further down before dropping off their student. Speed bumps in this parking lot are also suggested to slow traffic down.

Additional lighting on the play structure is also suggested to deter vandalism. Also window coverings in the courtyard classrooms would allow for code red lock down coverage.

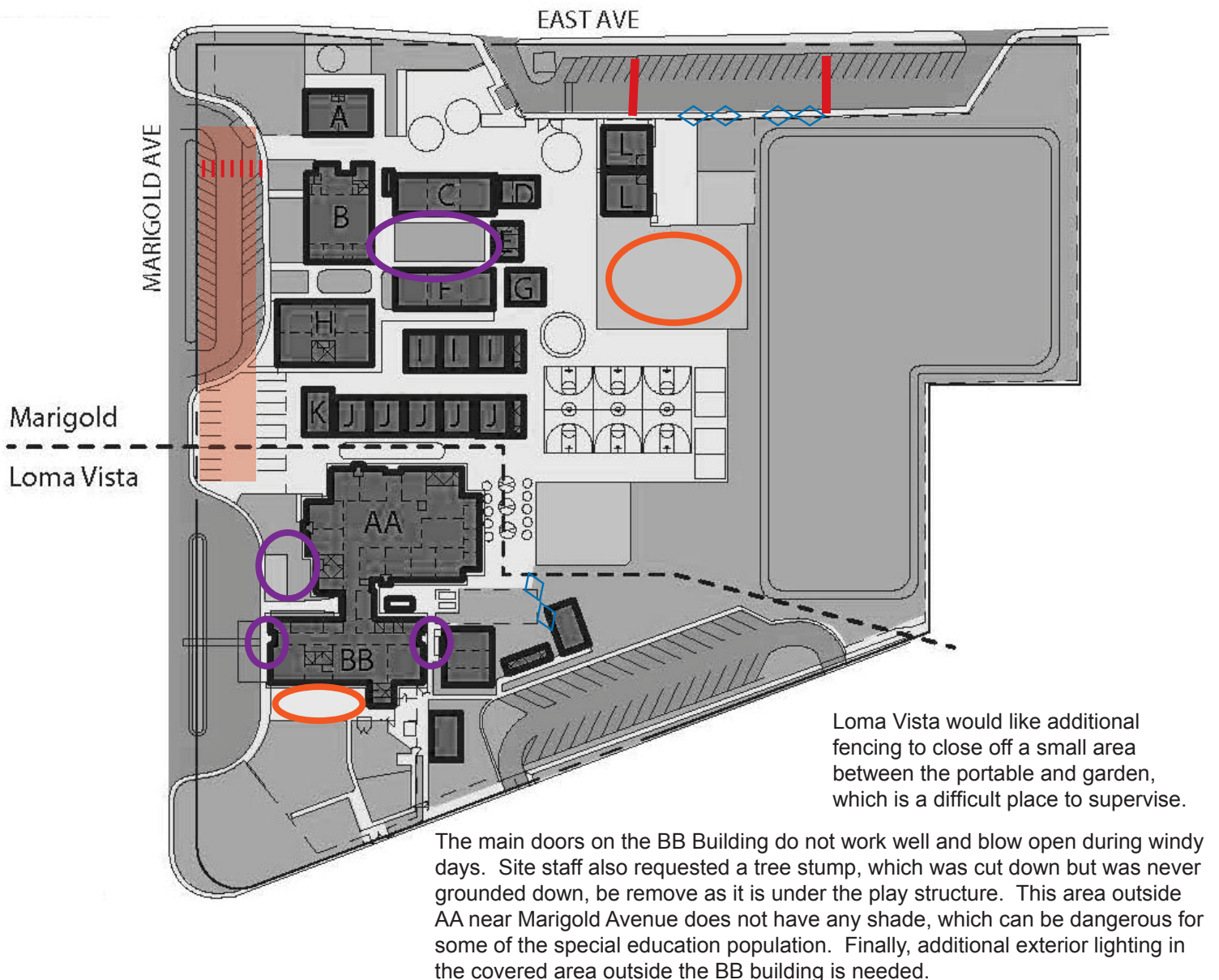

Legend

#	Priority Number	◇◇	New Fence / Gates	▨	Additional Striping
○	Additional Lighting	—	New Wall		New Cross Walk
○	Camera Coverage	○	Replace Door Locks/Doors	—	Speed Bumps
○	Other		Wood Replacement	⊗	New Sign

John A. McManus Elementary School

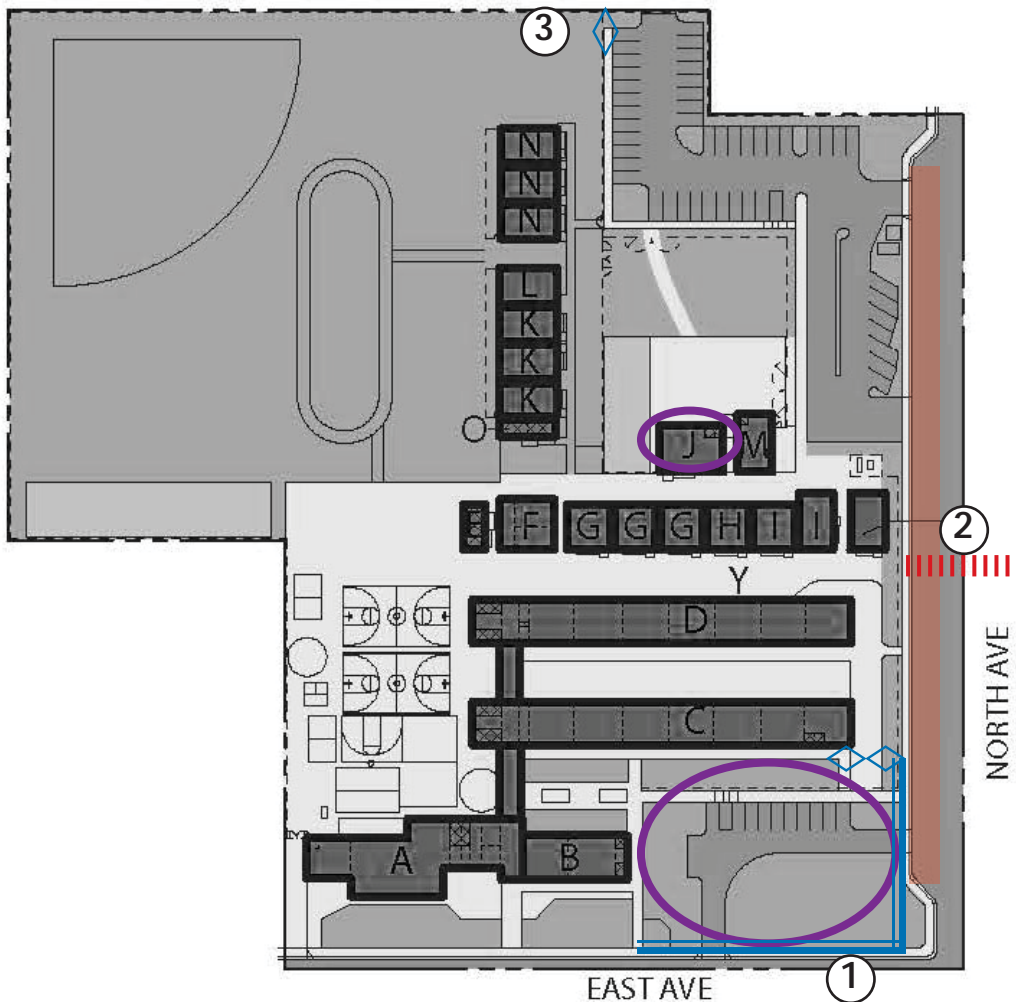

1. First priority is to wall off the East Avenue and North Ave corner of the school site. This small parking lot is used for drop-off and has two way traffic. Some people use it as a way to cut off the corner and not have to wait in line. The staff would like to see it become a Kindergarten play ground and turn J or one of the K portables into a front office which would have better connection to the parking lot and would allow visitors to check in before walking through the campus
2. Second priority is to add a crosswalk to North Avenue so students have a safer and more consolidated area for crossing the street than the current practise of jay-walking across where ever their parents have parked. To create this crosswalk, extending out the sidewalk passed the drop-off lanes should be considered. Increasing the striping on the drop-off curb cutout of the street may also help.
3. Finally, there is a gap in the fencing by the parking lot which could be closed off by a gate.

Legend

#	Priority Number	◇◇	New Fence / Gates	■	Additional Striping
○	Additional Lighting	—	New Wall		New Cross Walk
○	Camera Coverage	○	Replace Door Locks/Doors	—	Speed Bumps
○	Other	////	Wood Replacement	⊗	New Sign

Neal Dow Elementary School

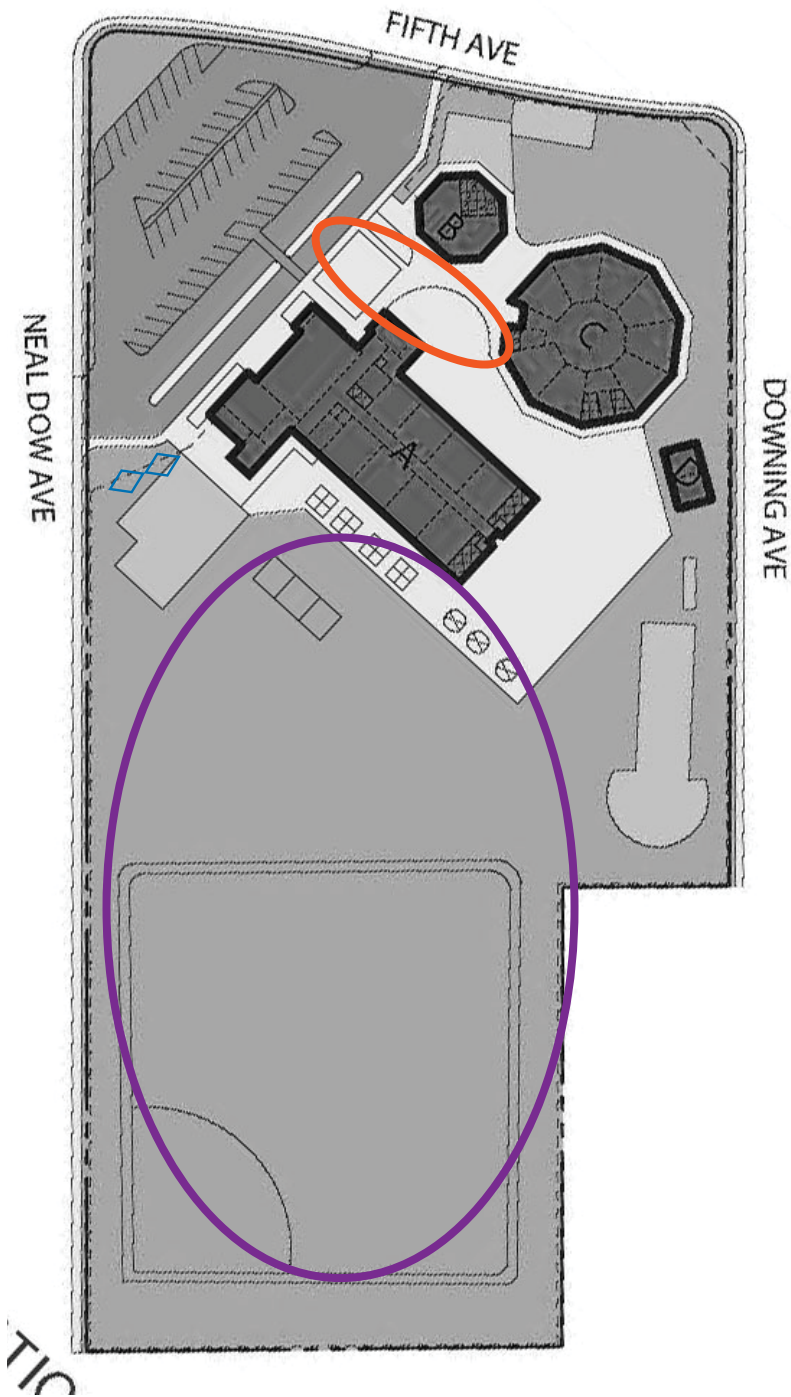

While the solar panels greatly improved lighting in the parking lots the front entrance plaza is somewhat dark.

There is a missing gate near the primary playground which is a concern for young children running out into the parking lot or street.

The play fields are very uneven with gofer holes and other dents and divots which are dangerous.

Legend

#	Priority Number	◇◇	New Fence / Gates	■	Additional Striping
○	Additional Lighting	▬▬	New Wall		New Cross Walk
○	Camera Coverage	○	Replace Door Locks/Doors	■	Speed Bumps
○	Other	////	Wood Replacement	⊠	New Sign

Parkview Elementary School

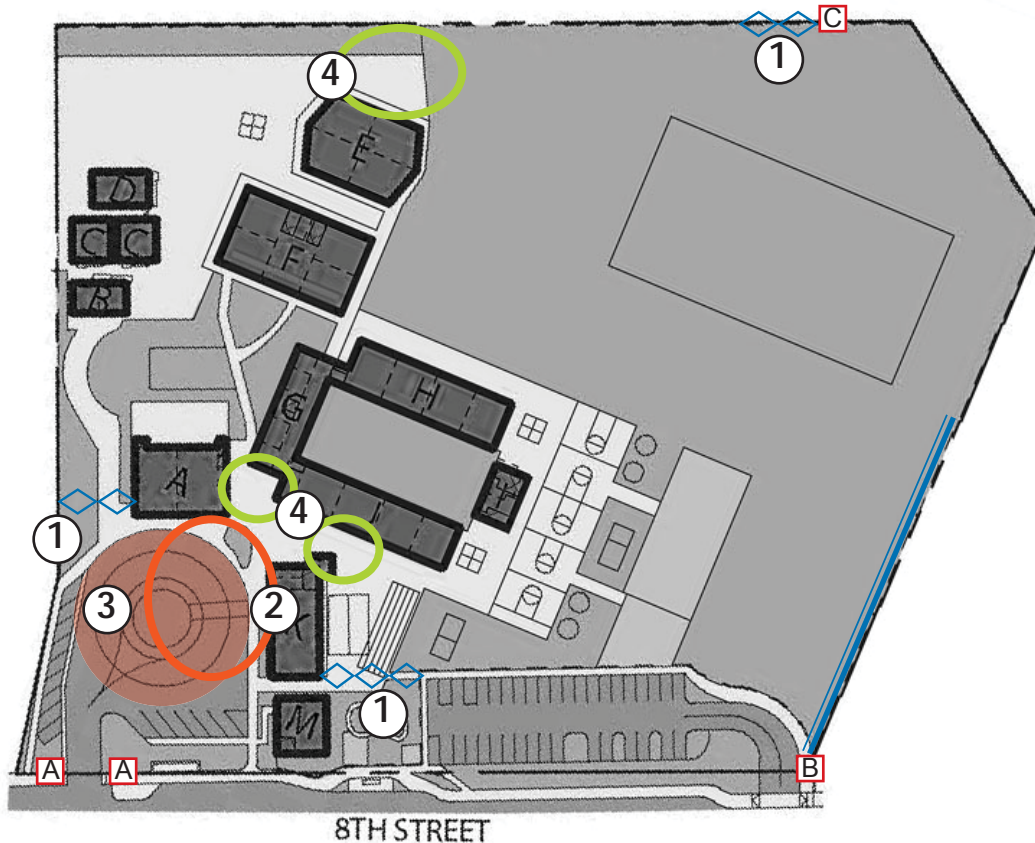

1. First priority is to add fencing and gates to close off side entrances to the school. These entrances allow visitors, intruders and sometimes dogs to enter the campus. By closing these areas off the pedestrian traffic during the day can be funneled by more populated areas closer to the office. A sign (C) is also requested to notify the community in the neighborhood that the gate will remain locked from 8:00am-3:00pm on school days.
2. Second priority is to increase the lighting around the Cafeteria. With the after school program operating until 6:00pm there are many days that it is dark when parents are picking up their students.
3. Additional striping on the drop-off area may help clarify the drop-off. Adding arrows and labels to the drive ways for no parking and bus loading. Another consideration is having the special education busses drop-off at the same curb as the regular buses would free up more drop-off for parents. Adding bike crossing warnings signs, sign (A), to the bike lane could also help prevent accidents with bike and vehicle traffic. Sign (B), at the entrance to the staff parking lot, would indicate there is no parent drop-off or pick-up in the staff parking lot.
4. Adding video to the areas circled in green would give eyes to the areas where people are climbing onto the roof and to the front area, which does not lend itself to fencing. The green area by Building E is secluded and difficult to supervise especial because the classrooms have no windows to the outside. Adding cameras there would give more ability to know what is going on in this area.

Legend

#	Priority Number	◇◇	New Fence / Gates	■	Additional Striping
○	Additional Lighting	—	New Wall		New Cross Walk
○	Camera Coverage	○	Replace Door Locks/Doors	—	Speed Bumps
○	Other	////	Wood Replacement	⊠	New Sign

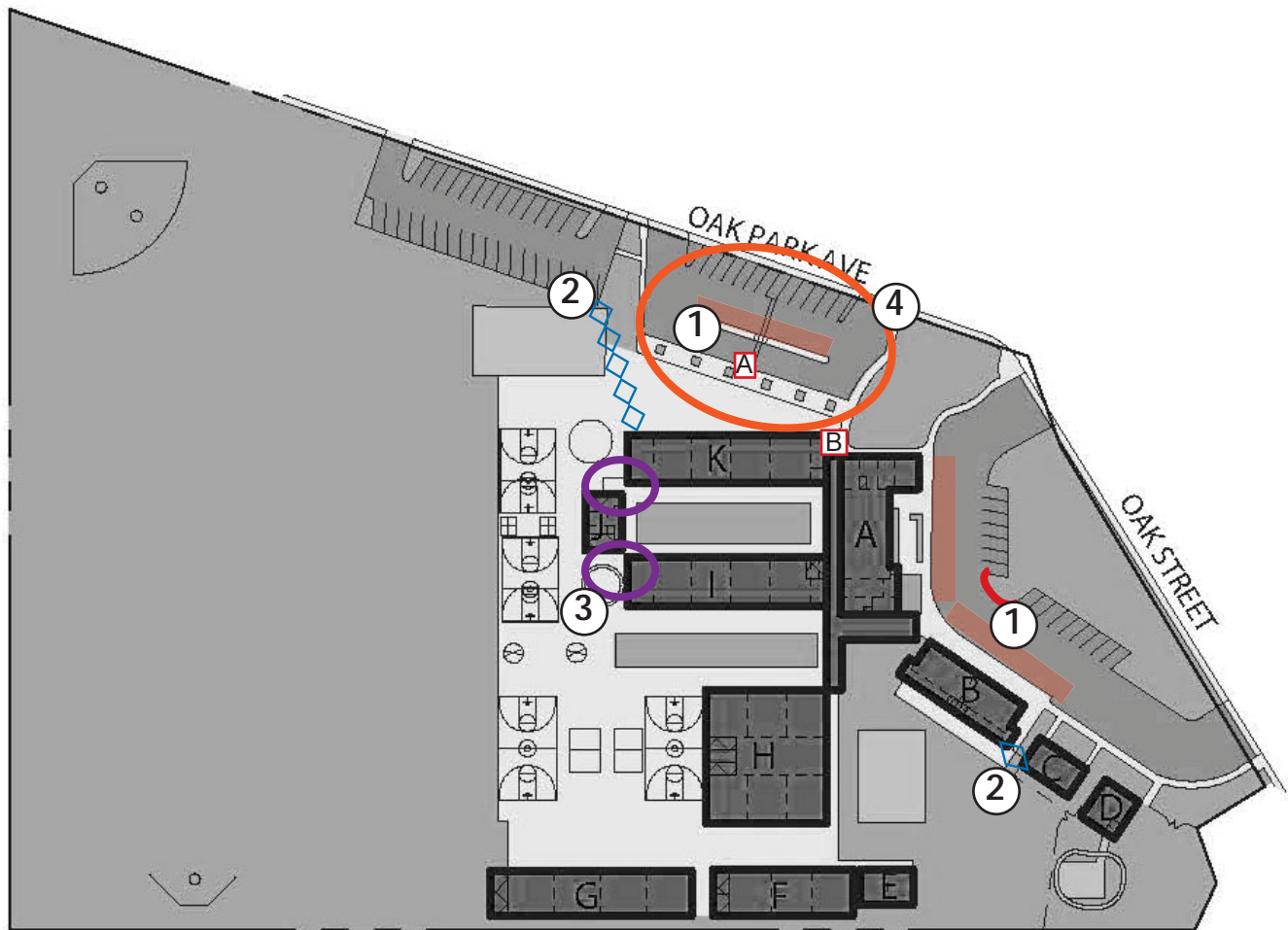

1. First priority is to add striping to the parent drop-off area on the Oakpark Avenue side, saying no parking with arrows and lines to separate lanes. A stop sign, Sign (A), at the cross walk may also help pick-up and drop-off traffic dangers. Sign (B), on the doors closes to the parking area on the A Building would notify visitors that this door remains closed during school hours and directs them to the front office. The Oak Street drop-off also needs striping to identify bus loading zones and a red curb on the side near Oak Street between the two parking areas to prevent parking that causes bottlenecks in the flow of traffic.
2. Second priority is to add a new fence from the staff parking lot edge to Building K to close off the playground and replace the small fence and gate between the B and C Buildings with a taller lockable gate. These additions would strengthen the perimeter around the school and funnel visitors to the office.
3. The doors at the end of the court yard are locked from both sides and have lead to staff being locked into the courtyard. Replacement to crash bars would improve safety and allow better exiting.

Legend

#	Priority Number	◇◇◇◇	New Fence / Gates	■	Additional Striping
○	Additional Lighting	▬▬▬	New Wall		New Cross Walk
○	Camera Coverage	○	Replace Door Locks/Doors	—	Speed Bumps
○	Other	////	Wood Replacement	⊠	New Sign

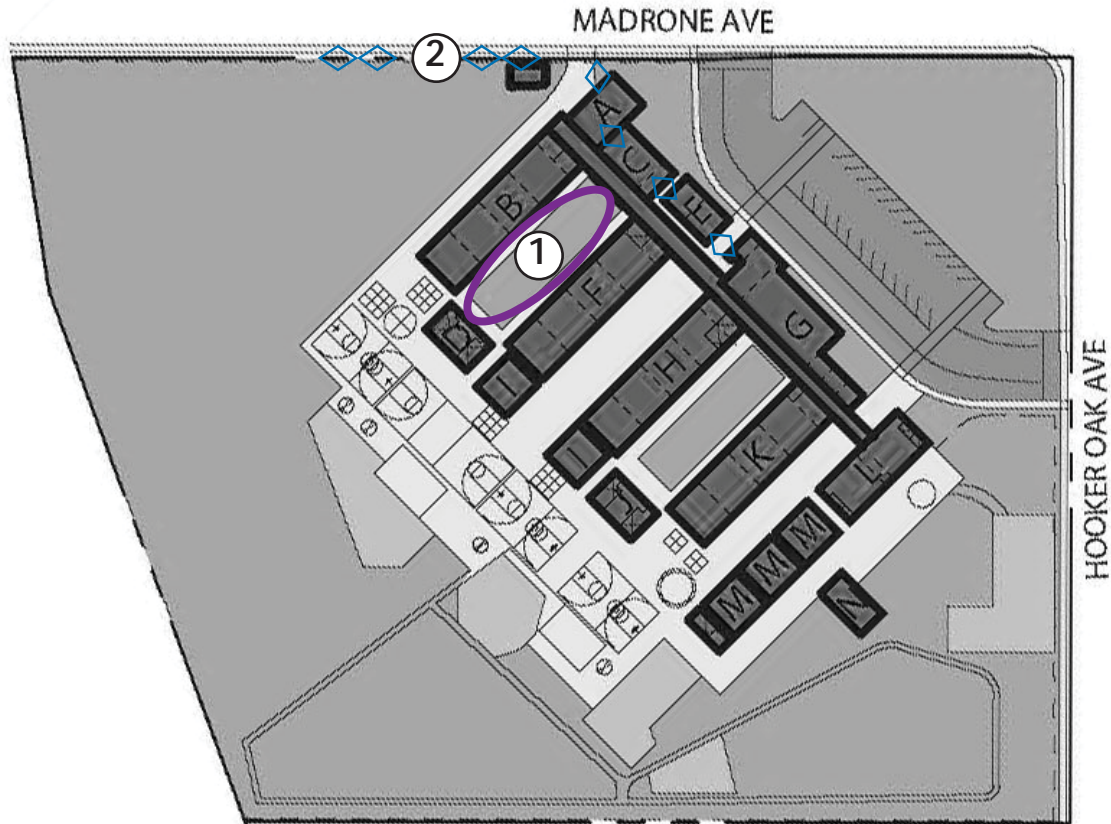

1. First priority is to redo the courtyard landscaping and hardscape to remove tripping hazards. Tree roots and flag stone paving have created dangerous conditions for student dining.
2. Adding fencing to the gaps in the fence on Madrone Avenue and between the edge of campus and the A Building and between the A, C and E Buildings. Between E and G a fence with a gate and crash bar would allow for exiting at the end of the day but would close in the perimeter.

Legend

#	Priority Number		New Fence / Gates		Additional Striping
	Additional Lighting		New Wall		New Cross Walk
	Camera Coverage		Replace Door Locks/Doors		Speed Bumps
	Other		Wood Replacement		New Sign

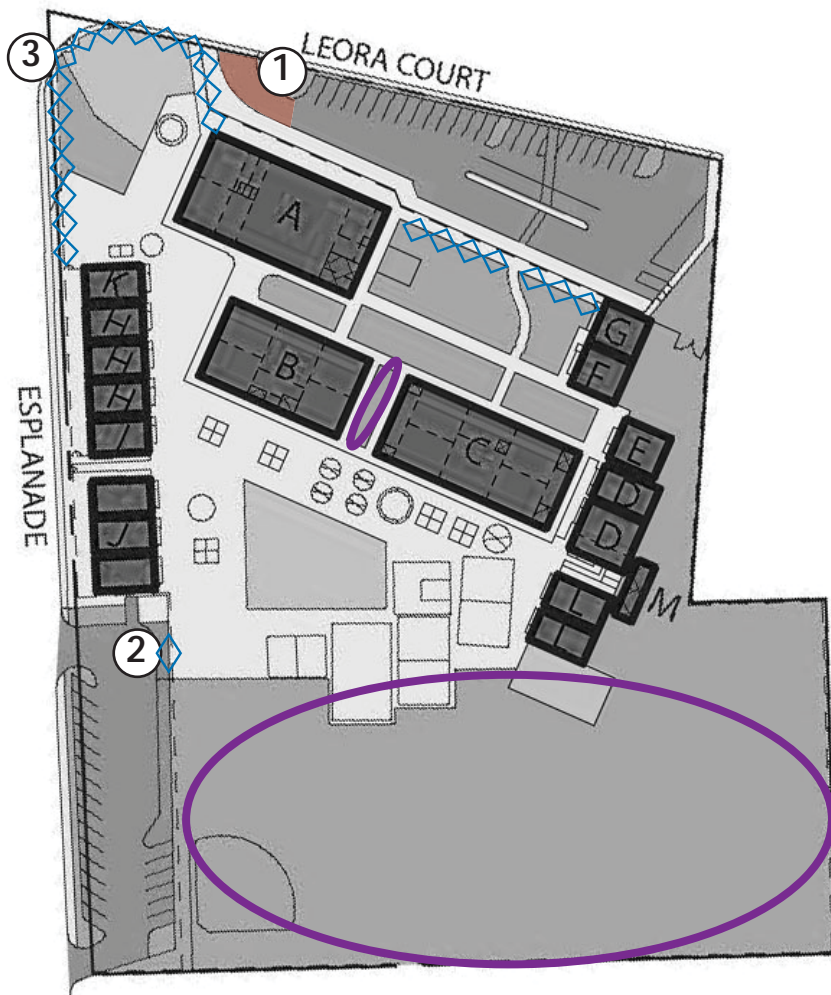

1. First priority is to add striping and traffic barrier to the entrance off of Leora Court. Because of the current shape and width parents pull up thinking they can park there without impeding incoming traffic but that is not the case. Adding cones to this area and smoothing out the curve may stop parents from parking in this area. Striping on the drive way saying no parking and arrows could also help.
2. Replace current gate with a gate that opens out and has a crash bar like originally requested.

In addition to the prioritized concerns, the field at Shasta was not redone like the other campuses a few years ago. The field is very uneven. Also Buildings B and C are not currently connected which just allows rain into seating area. Site staff would like to see the roofs connect.

Legend

	Priority Number		New Fence / Gates		Additional Striping
	Additional Lighting		New Wall		New Cross Walk
	Camera Coverage		Replace Door Locks/Doors		Speed Bumps
	Other		Wood Replacement		New Sign

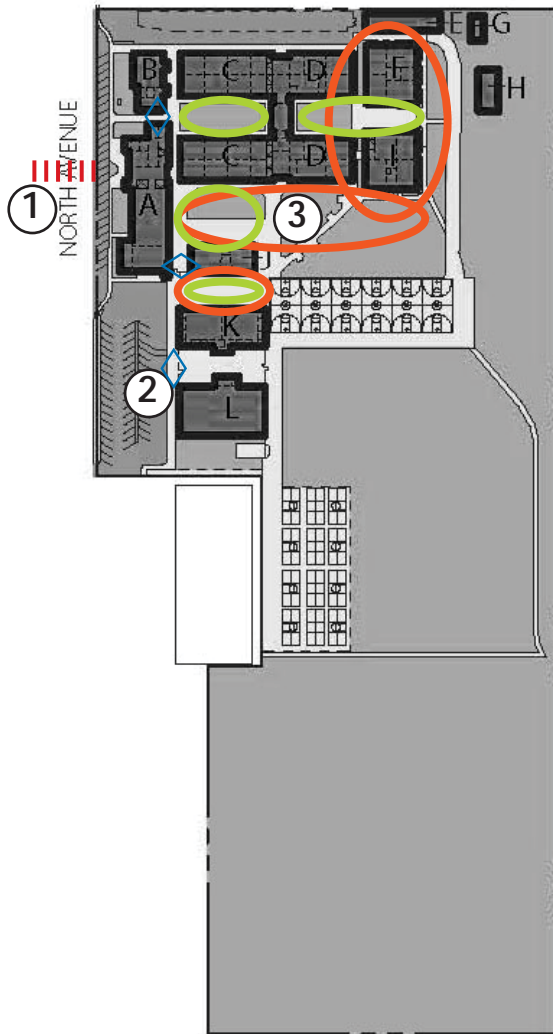

1. First priority is to add a cross walk across North Ave to give students a marked and consolidated area to cross the street. Restriping the existing cross walks so they are more visible would also help improve student safety.
2. Replace current gates with crash bars instead of chaining these areas closed. The chains require someone with a key to unlock the gates and in an emergency this may take too much time.
3. Increase lighting around the back buildings, Buildings E and I and in the courtyard by Buildings B and C. The exterior lighting that is under the covered area by Building K is very hard to clean. Replacing it with something that would not get as dirty and covered with bugs would add to the aesthetics of the campus. Additional video coverage in areas highlighted in green would help deter vandalism and inappropriate behavior that occurs in off-hours around the campus in the more hidden areas from the street.

Legend

#	Priority Number	◇◇	New Fence / Gates	■	Additional Striping
○	Additional Lighting	══	New Wall		New Cross Walk
○	Camera Coverage	○	Replace Door Locks/Doors	■	Speed Bumps
○	Other	////	Wood Replacement	⊗	New Sign

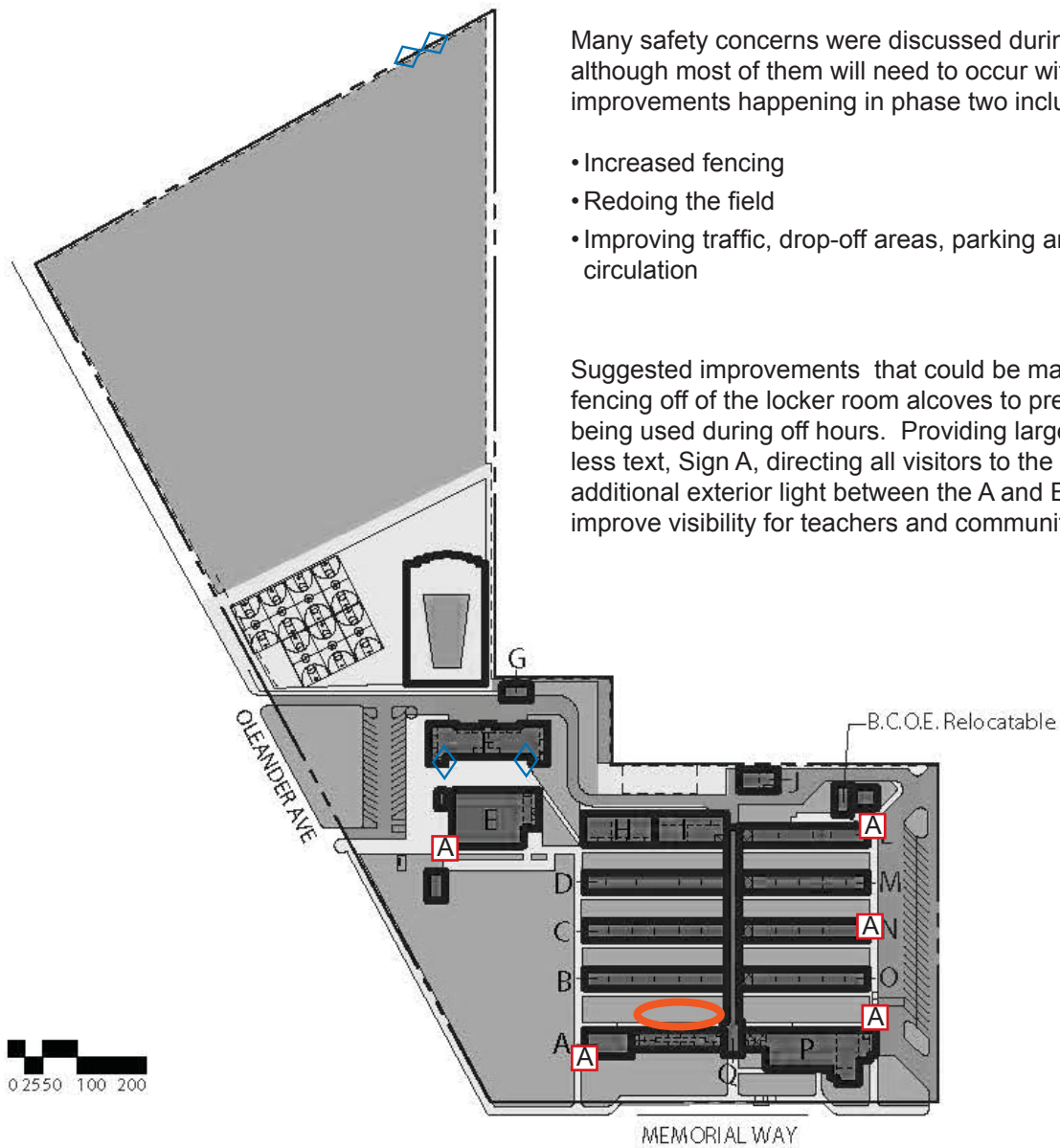

Legend

#	Priority Number	◇◇	New Fence / Gates	■	Additional Striping
○	Additional Lighting	══	New Wall		New Cross Walk
○	Camera Coverage	○	Replace Door Locks/Doors	—	Speed Bumps
○	Other	////	Wood Replacement	⊠	New Sign

Marsh Junior High School

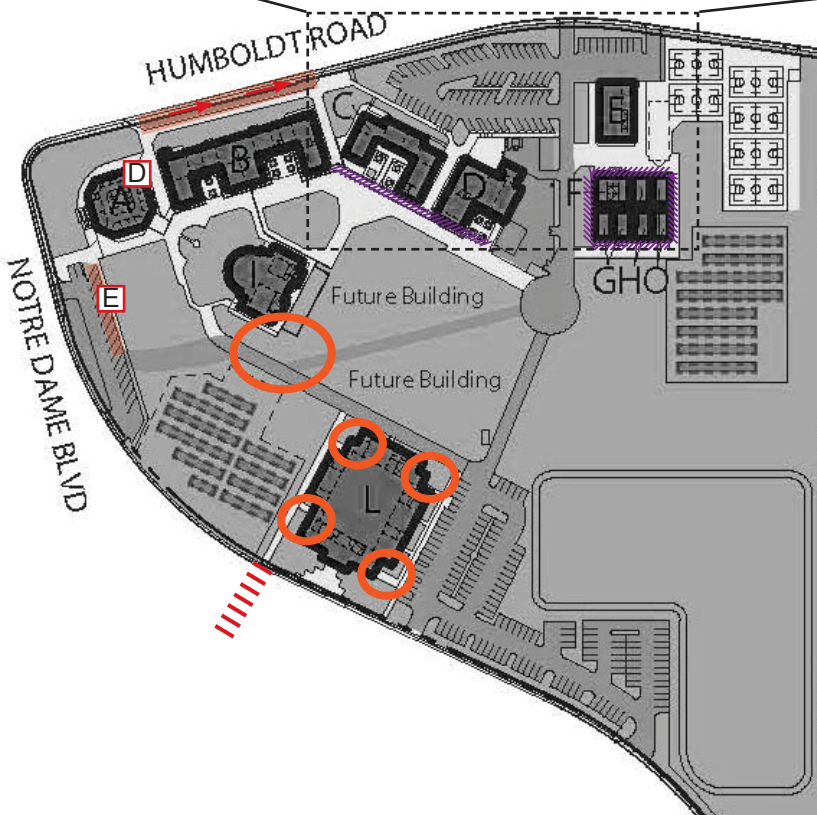
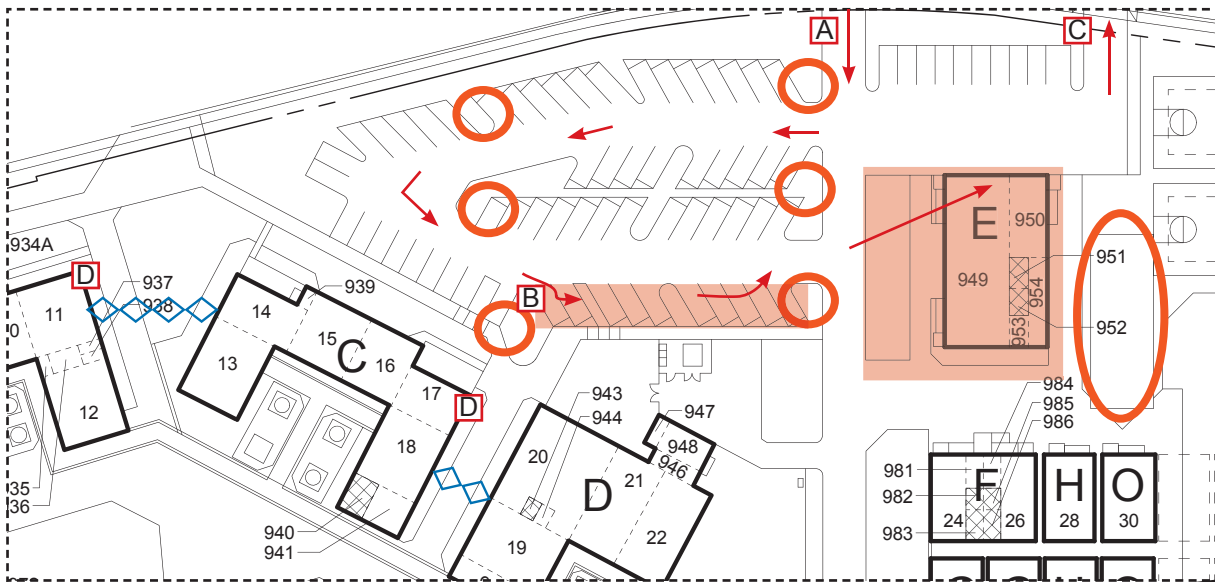

Safety improvements included adding additional striping and arrows to the drop off area on Humboldt Road. An additional suggestion was to redesign the traffic flow in the parking lot off of Humboldt Road so there is a one way entrance, Sign (A) entrance only, and one way exit, Sign (C) exit only, and removing some of the parking to create a drop-off zone, Sign (B) drop-off zone no parking. With the removal of the cafeteria building, the line to the exit can be separated from the entrance. The lighting in this parking lot and around the gym trips the breaker on a regular bases. Fixing the electrical problem would increase the exterior lighting safety. Adding lighting near the library and in the outdoor covered area would eliminate darker parts of the campus. Adding fencing with gates between the B, C and D Buildings with signs, Sign (D), directing visitors to the office would strengthen the perimeter of the campus. With the new drop off created the parking lot off of Notre Dame Blvd. can be designated for visitor parking with Sign (E) noting visitor parking. A new cross walk would build a better bike and pedestrian crossing in connection with the pathway that already exists. Finally replacing the wooden covered walkways and skirting around the portables will help bug and other animal infestations.

Legend

#	Priority Number	◆◆	New Fence / Gates	■	Additional Striping
○	Additional Lighting	—	New Wall		New Cross Walk
○	Camera Coverage	○	Replace Door Locks/Doors	—	Speed Bumps
○	Other		Wood Replacement	⊠	New Sign

Chico and Inspire High School

Meeting where held with Chico High and Inspire to discuss the safety concerns on both campus. Each campus priorities are as follows:

Inspire High School

1. First priority is to improve exterior lighting and provide video surveillance in the pathway from the parking lot along the side of the Office. Because this path has mostly the sides of the buildings verses the front doors there are no lights from the buildings.
2. Second priority is to provide more exterior lighting between the portables and proved a different way for turning on the existing lights in the new portables. Currently teachers must remember to leave the switch on inside the classroom for the exterior lights. This requirement means that lights are inconstantly left on or off. When off and in the dark area between the portables are the places and times that most vandalism occurs. Cameras in the quad and walkways would provide better coverage of the whole campus.
3. Third priority is increasing security around the bike racks with fencing and video surveillance.

Chico High School

1. First priority is the add window coverings to the New Classroom Building especially on the West Sacramento Avenue side of the building.
2. Second priority to the add the cameras that have been wired for in the New Classroom Building but the equipment has not been installed. Another area in need of camera surveillance is in the courtyard of the C Building. An exterior plug in this area attracts unauthorized use of the area during non-school hours.
3. The third priority is to add and/or fix exterior lighting along the gym and central quad areas. This space is a pathway to the main parking lot and is utilized for many evening events. Proper lighting would increase the safety of those visitors exiting events.

In addition the prioritized items discussion included providing more secure exterior outlet covers for electrical plugs to discourage unauthorized use. Also the bike enclosers have opening which need to be closed on the campus side to discourage theft.

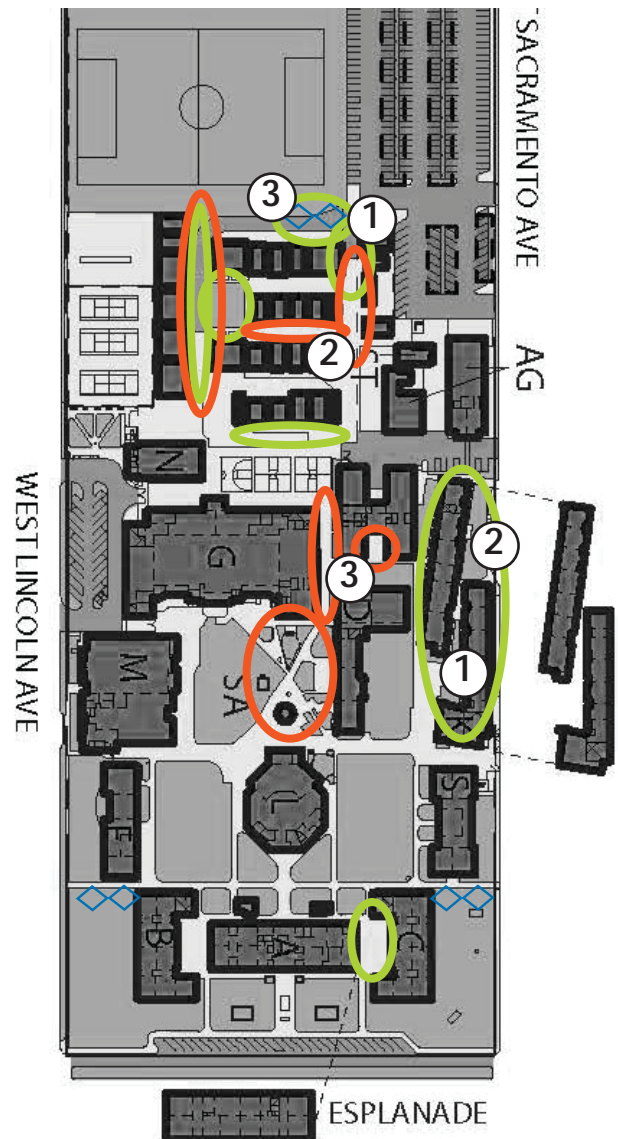

Legend

#	Priority Number	◇◇	New Fence / Gates	■	Additional Striping
○	Additional Lighting	▬▬	New Wall		New Cross Walk
○	Camera Coverage	○	Replace Door Locks/Doors	■	Speed Bumps
○	Other	////	Wood Replacement	⊠	New Sign

Pleasant Valley High School

1. First priority is to change the traffic flow in the main parking lot. Creating an entrance only off of East at Sign(A) would allow two lanes of traffic to enter the site, one making right turns and one making lefts. Sign (A) would read entrance only. The other entrance off of East would become an exit only with Sign (B) facing the street saying do not enter. Sign (C) would be directional exit signs. Additional swivel and zoom cameras would also be added to the parking lot

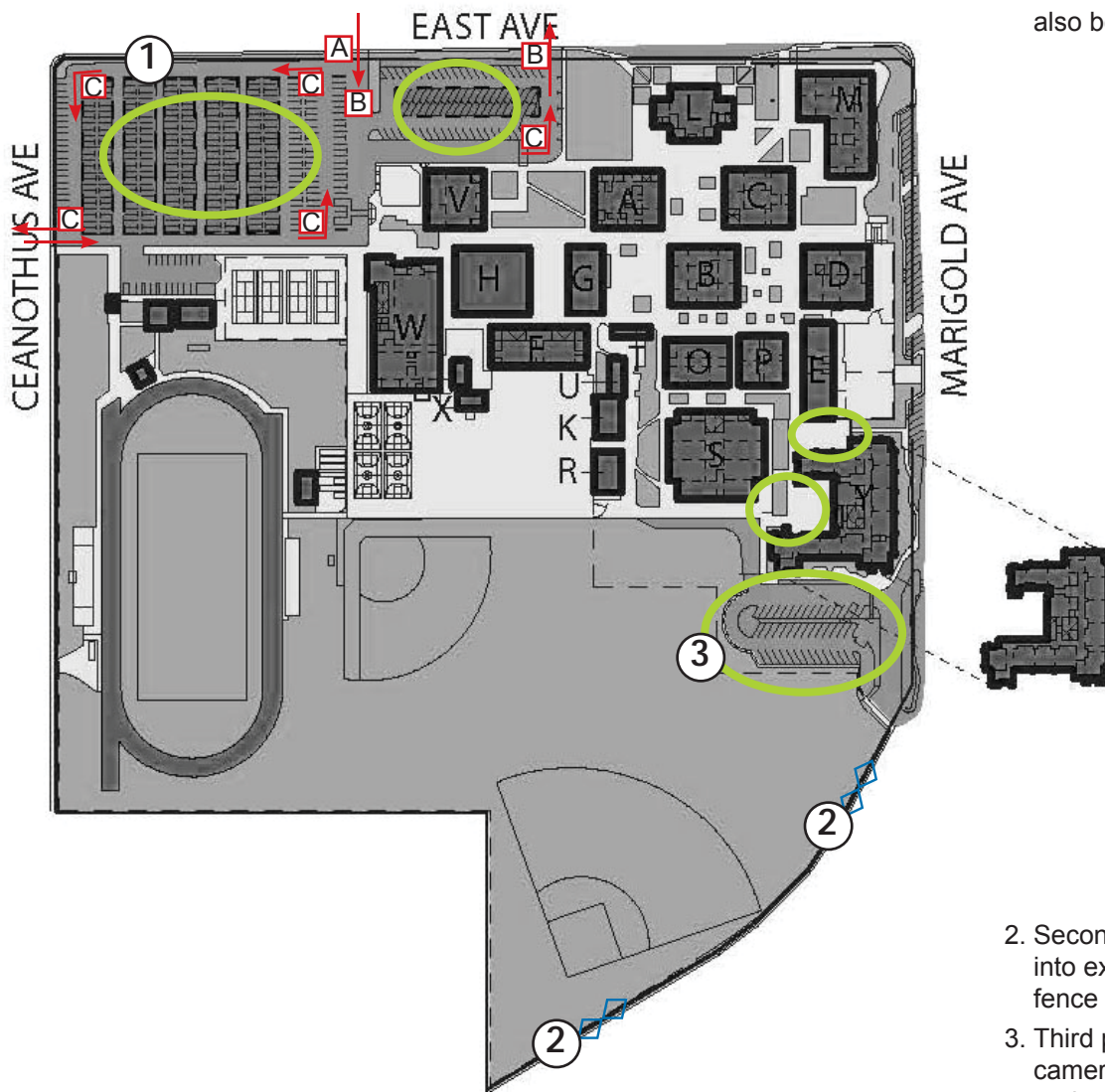

2. Second priority is to add gates into existing gaps in the perimeter fence around the field area.
3. Third priority is to add video cameras to the new parking lot and court yard around the Yale building.

Legend

#	Priority Number	◇◇	New Fence / Gates	■	Additional Striping
○	Additional Lighting	—	New Wall		New Cross Walk
○	Camera Coverage	○	Replace Door Locks/Doors	—	Speed Bumps
○	Other	///	Wood Replacement	⊠	New Sign

Fair View High School, AFC and Oakdale

1. First priority is to add window coverings to window coverings to the C, E and G Buildings. These original wings, no longer have window coverings which make lock downs less effective because there is no way to block the view into the classrooms.
2. Second priority is to increase the exterior lighting around the campus. The areas highlighted in the thicker line are well traversed pathways to parking and building entrances that are not lit because the path is located away from the building lights over entrances doors. The thinner outlined areas are lit but with an inadequate amount of light to feel safe.
3. The third priority is adding a cover to a gas pipe which was broken by a lawn mower this year to prevent any future damage and possible gas leaks.

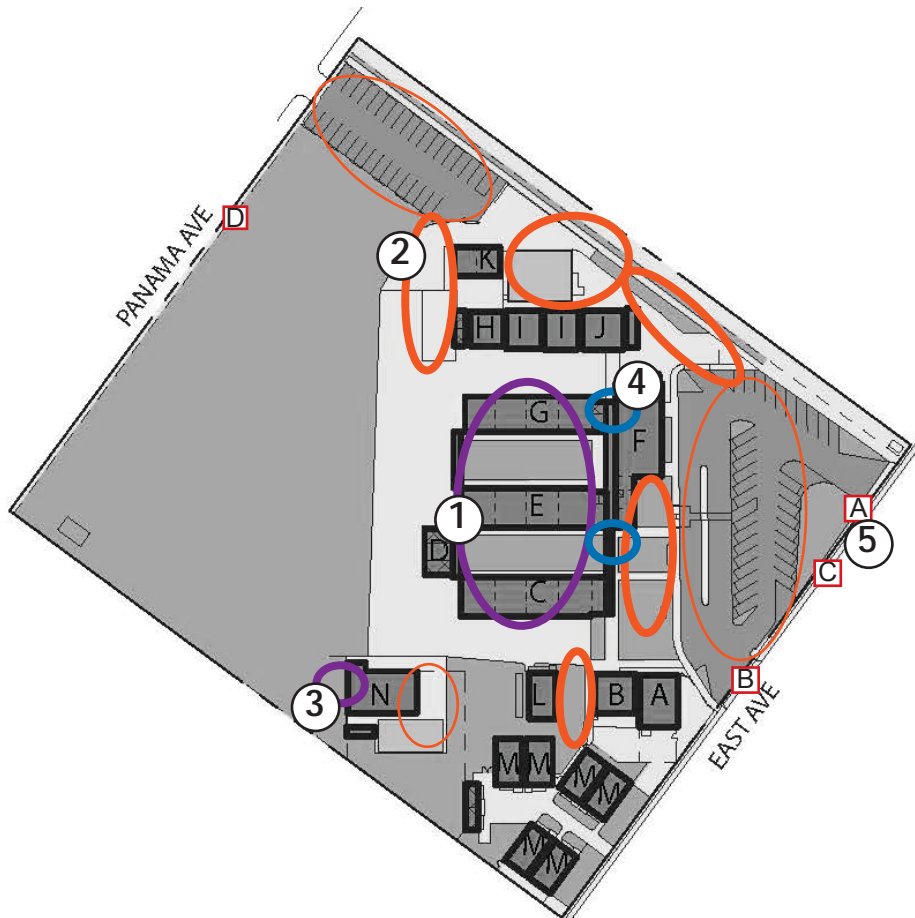

4. The fourth priority is to replace/ fix the glass doors at both ends of the main entry hallway. These original doors do not close on their own and require force to lock which could be dangerous in a lockdown when trying to quickly close a site.
5. The final improvement would be to add signage around campus. Sign (A) would denote entrance only while Sign (B) is exit only. Sign (C) would be a monument sign with the school name like many other campuses have out front. Sign (D) would notify visitors coming through the opening in the fence that the school grounds are closed during school hours.

Legend

#	Priority Number	◇◇	New Fence / Gates	■	Additional Striping
○	Additional Lighting	—	New Wall		New Cross Walk
○	Camera Coverage	○	Replace Door Locks/Doors	—	Speed Bumps
○	Other	////	Wood Replacement	⊗	New Sign

1. First priority is to add more controlled entrance in the main hallway. A door or gate would notify visitors to stop and be greeted instead of walking down the corridor. A television with office location and daily meeting schedule would improve communication to visitors. Further consideration on adding surveillance cameras to the entry way could give staff at the ends of the building a more secure feeling by being able to see who is entering the building

2. Second priority would be to increase the exterior lighting around the B Building and adjacent parking area for evening events and to discourage encampment around the portable ramp area.

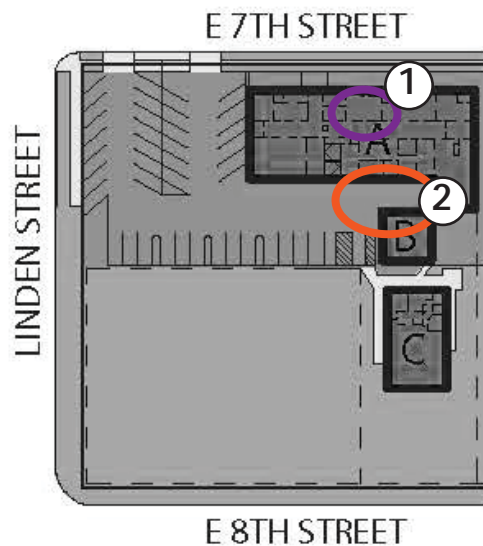

Legend

#	Priority Number	◇◇	New Fence / Gates	■	Additional Striping
○	Additional Lighting	▬▬	New Wall		New Cross Walk
○	Camera Coverage	○	Replace Door Locks/Doors	■	Speed Bumps
○	Other	////	Wood Replacement	⊠	New Sign



INTEGRATED
educational planning & programming LLC

www.facebook.com/iep2.co

916.955.5208

4411 Chardonnay Dr SE
Lacey, Washington 98513